

**AGENDA  
BOARD OF TRUSTEES  
TOWN OF WESTCLIFFE  
THURSDAY, APRIL 7, 2022  
PATTERSON HALL  
SPECIAL MEETING  
4:30 P.M.  
Join by Zoom  
Meeting ID: 871 7954 3995  
Passcode: 137622  
By Phone: 669-900-6833**

1. Call to Order
  2. Pledge of Allegiance
  3. Roll Call
  4. Recognition of Visitors
  5. Order of Business
    - a. PUBLIC HEARING for a new Hotel & Restaurant license at 215 Main Street for Yamabeeza, LLC.
    - b. Consideration of request to approve a Hotel & Restaurant license at 215 Main Street for Yamabeeza, LLC.
- Adjourn



## Application Documents Checklist and Worksheet

**Instructions:** This checklist should be utilized to assist applicants with filing all required documents for licensure. All documents must be properly signed and correspond with the name of the applicant exactly. All documents must be typed or legibly printed. Upon final State approval the license will be mailed to the local licensing authority. Application fees are nonrefundable. **Questions? Visit: [SBG.Colorado.gov/Liquor](http://SBG.Colorado.gov/Liquor) for more information**

| Items submitted, please check all appropriate boxes completed or documents submitted |  |
|--|--|
| <b>I.</b>  | <b>Applicant information</b><br><input checked="" type="checkbox"/> A. Applicant/Licensee identified<br><input checked="" type="checkbox"/> B. State sales tax license number listed or applied for at time of application<br><input checked="" type="checkbox"/> C. License type or other transaction identified<br><input type="checkbox"/> D. Return originals to local authority (additional items may be required by the local licensing authority)<br><input type="checkbox"/> E. All sections of the application need to be completed<br><input type="checkbox"/> F. Master file applicants must include the Application for Master File form DR 8415 and applicable fees to this Retail License Application  |
| <b>II.</b>   | <b>Diagram of the premises</b><br><input checked="" type="checkbox"/> A. No larger than 8 1/2" X 11"<br><input checked="" type="checkbox"/> B. Dimensions included (does not have to be to scale). Exterior areas should show type of control (fences, walls, entry/exit points, etc.)<br><input checked="" type="checkbox"/> C. Separate diagram for each floor (if multiple levels)<br><input checked="" type="checkbox"/> D. Kitchen - identified if Hotel and Restaurant<br><input checked="" type="checkbox"/> E. Bold/Outlined Licensed Premises   |
| <b>III.</b>  | <b>Proof of property possession (One Year Needed)</b><br><input type="checkbox"/> A. Deed in name of the applicant (or) (matching question #2) date stamped / filed with County Clerk<br><input checked="" type="checkbox"/> B. Lease in the name of the applicant (or) (matching question #2)<br><input type="checkbox"/> C. Lease assignment in the name of the applicant with proper consent from the landlord and acceptance by the applicant<br><input type="checkbox"/> D. Other agreement if not deed or lease. (matching question #2)  |
| <b>IV.</b>   | <b>Background information (DR 8404-I) and financial documents</b><br><input type="checkbox"/> A. Complete DR 8404-I for each principal (individuals with more than 10% ownership, officers, directors, partners, members)<br><input type="checkbox"/> B. Fingerprints taken and submitted to the appropriate Local Licensing Authority through an approved state vendor.<br><b>Do not complete fingerprint cards prior to submitting your application.</b><br>The Vendors are as follows:<br><b>IdentoGO</b> – <a href="https://uenroll.identogo.com/">https://uenroll.identogo.com/</a> Phone: 844-539-5539 (toll-free)<br><b>Colorado Fingerprinting</b> – <a href="http://www.coloradofingerprinting.com">http://www.coloradofingerprinting.com</a><br>Appointment Scheduling Website: <a href="http://www.coloradofingerprinting.com/cabs/">http://www.coloradofingerprinting.com/cabs/</a><br>Phone: 720-292-2722 Toll Free: 833-224-2227<br><b>Details about the vendors and fingerprinting in Colorado can be found on CBI's website here:</b><br><a href="https://cbi.colorado.gov/sections/biometric-identification-and-records-unit/employment-and-background-checks">https://cbi.colorado.gov/sections/biometric-identification-and-records-unit/employment-and-background-checks</a><br><input type="checkbox"/> C. Purchase agreement, stock transfer agreement, and/or authorization to transfer license<br><input type="checkbox"/> D. List of all notes and loans (Copies to also be attached) |
| <b>V.</b>  | <b>Sole proprietor/husband and wife partnership (if applicable)</b><br><input type="checkbox"/> A. Form DR 4679<br><input type="checkbox"/> B. Copy of State issued Driver's License or Colorado Identification Card for each applicant  |
| <b>VI.</b>   | <b>Corporate applicant information (if applicable)</b><br><input type="checkbox"/> A. Certificate of Incorporation<br><input type="checkbox"/> B. Certificate of Good Standing<br><input type="checkbox"/> C. Certificate of Authorization if foreign corporation (out of state applicants only)   |
| <b>VII.</b>  | <b>Partnership applicant information (if applicable)</b><br><input type="checkbox"/> A. Partnership Agreement (general or limited).<br><input type="checkbox"/> B. Certificate of Good Standing  |
| <b>VIII.</b>   | <b>Limited Liability Company applicant information (if applicable)</b><br><input checked="" type="checkbox"/> A. Copy of articles of organization<br><input checked="" type="checkbox"/> B. Certificate of Good Standing<br><input checked="" type="checkbox"/> C. Copy of Operating Agreement (if applicable)<br><input type="checkbox"/> D. Certificate of Authority if foreign LLC (out of state applicants only)   |
| <b>IX.</b>   | <b>Manager registration for Hotel and Restaurant, Tavern, Lodging &amp; Entertainment, and Campus Liquor Complex licenses when included with this application</b><br><input type="checkbox"/> A. \$75.00 fee<br><input type="checkbox"/> B. Individual History Record (DR 8404-I)<br><input type="checkbox"/> C. If owner is managing, no fee required   |

| Name  | Type of License | Account Number  |             |  |
|---|-----------------|---|-------------|--|
| 7. Is the applicant (including any of the partners if a partnership; members or managers if a limited liability company; or officers, stockholders or directors if a corporation) or managers under the age of twenty-one years?  |                 | Yes <input type="checkbox"/> No <input checked="" type="checkbox"/> |             |  |
| 8. Has the applicant (including any of the partners if a partnership; members or managers if a limited liability company; or officers, stockholders or directors if a corporation) or managers ever (in Colorado or any other state):   |                 |   |             |  |
| a. Been denied an alcohol beverage license?   |                 | <input type="checkbox"/> <input checked="" type="checkbox"/>        |             |  |
| b. Had an alcohol beverage license suspended or revoked?  |                 | <input type="checkbox"/> <input checked="" type="checkbox"/>        |             |  |
| c. Had interest in another entity that had an alcohol beverage license suspended or revoked?  |                 | <input type="checkbox"/> <input checked="" type="checkbox"/>        |             |  |
| If you answered yes to 8a, b or c, explain in detail on a separate sheet.   |                 |   |             |  |
| 9. Has a liquor license application (same license class), that was located within 500 feet of the proposed premises, been denied within the preceding two years? If "yes", explain in detail.   |                 | <input type="checkbox"/> <input checked="" type="checkbox"/>        |             |  |
| 10. Are the premises to be licensed within 500 feet, of any public or private school that meets compulsory education requirements of Colorado law, or the principal campus of any college, university or seminary?  |                 | <input type="checkbox"/> <input checked="" type="checkbox"/>        |             |  |
| or<br>Waiver by local ordinance? <input type="checkbox"/> <input type="checkbox"/><br>Other: _____  |                 |   |             |  |
| 11. Is your Liquor Licensed Drugstore (LLDS) or Retail Liquor Store (RLS) within 1500 feet of another retail liquor license for off-premises sales in a jurisdiction with a population of greater than (>) 10,000? NOTE: The distance shall be determined by a radius measurement that begins at the principal doorway of the LLDS/RLS premises for which the application is being made and ends at the principal doorway of the Licensed LLDS/RLS. |                 | <input type="checkbox"/> <input checked="" type="checkbox"/>        |             |  |
| 12. Is your Liquor Licensed Drugstore (LLDS) or Retail Liquor Store (RLS) within 3000 feet of another retail liquor license for off-premises sales in a jurisdiction with a population of less than (<) 10,000? NOTE: The distance shall be determined by a radius measurement that begins at the principal doorway of the LLDS/RLS premises for which the application is being made and ends at the principal doorway of the Licensed LLDS/RLS.    |                 | <input type="checkbox"/> <input checked="" type="checkbox"/>        |             |  |
| 13 a. For additional Retail Liquor Store only. Was your Retail Liquor Store License issued on or before January 1, 2016?  |                 | <input type="checkbox"/> <input checked="" type="checkbox"/>        |             |  |
| 13 b. Are you a Colorado resident?  |                 | <input checked="" type="checkbox"/> <input type="checkbox"/>        |             |  |
| 14. Has a liquor or beer license ever been issued to the applicant (including any of the partners, if a partnership; members or manager if a Limited Liability Company; or officers, stockholders or directors if a corporation)? If yes, identify the name of the business and list any <u>current</u> financial interest in said business including any loans to or from a licensee.  |                 | <input type="checkbox"/> <input checked="" type="checkbox"/>        |             |  |
| 15. Does the applicant, as listed on line 2 of this application, have legal possession of the premises by ownership, lease or other arrangement?<br><input type="checkbox"/> Ownership <input checked="" type="checkbox"/> Lease <input type="checkbox"/> Other (Explain in Detail) _____   |                 | <input type="checkbox"/> <input type="checkbox"/>                   |             |  |
| a. If leased, list name of landlord and tenant, and date of expiration, exactly as they appear on the lease:  |                 |   |             |  |
| Landlord  | Tenant          | Expires   |             |  |
| ALISON BOYD   | NAMABEEZIA, LLC | 06/01/23  |             |  |
| b. Is a percentage of alcohol sales included as compensation to the landlord? If yes, complete question 16.   |                 | <input type="checkbox"/> <input checked="" type="checkbox"/>        |             |  |
| c. Attach a diagram that designates the area to be licensed in black bold outline (including dimensions) which shows the bars, brewery, walls, partitions, entrances, exits and what each room shall be utilized for in this business. This diagram should be no larger than 8 1/2" X 11".  |                 |   |             |  |
| 16. Who, besides the owners listed in this application (including persons, firms, partnerships, corporations, limited liability companies) will loan or give money, inventory, furniture or equipment to or for use in this business; or who will receive money from this business? Attach a separate sheet if necessary.   |                 |   |             |  |
| Last Name   | First Name      | Date of Birth   | FEIN or SSN | Interest/Percentage  |
| N/A   | N/A             | N/A   | N/A         | N/A  |
| Last Name   | First Name      | Date of Birth   | FEIN or SSN | Interest/Percentage  |
| N/A   | N/A             | N/A   | N/A         | N/A  |
| Attach copies of all notes and security instruments and any written agreement or details of any oral agreement, by which any person (including partnerships, corporations, limited liability companies, etc.) will share in the profit or gross proceeds of this establishment, and any agreement relating to the business which is contingent or conditional in any way by volume, profit, sales, giving of advice or consultation.                |                 |   |             |  |
| 17. Optional Premises or Hotel and Restaurant Licenses with Optional Premises:<br>Has a local ordinance or resolution authorizing optional premises been adopted?   |                 | <input type="checkbox"/> <input checked="" type="checkbox"/>        |             |  |
| Number of additional Optional Premise areas requested. (See license fee chart)  |                 | <input type="text"/>  |             |  |
| 18. For the addition of a Sidewalk Service Area per Regulation 47-302(A)(4), include a diagram of the service area and documentation received from the local governing body authorizing use of the sidewalk. Documentation may include but is not limited to a statement of use, permit, easement, or other legal permissions.  |                 |   |             |  |
| 19. Liquor Licensed Drugstore (LLDS) applicants, answer the following:  |                 |   |             |  |
| a. Is there a pharmacy, licensed by the Colorado Board of Pharmacy, located within the applicant's LLDS premise?<br>If "yes" a copy of license must be attached.  |                 |   |             | <input type="checkbox"/> <input checked="" type="checkbox"/> |

| Name   | Type of License                   | Account Number |             |        |
|--|-----------------------------------|----------------|-------------|--------|
| <p>20. Club Liquor License applicants answer the following: <b>Attach a copy of applicable documentation</b></p> <p>a. Is the applicant organization operated solely for a national, social, fraternal, patriotic, political or athletic purpose and not for pecuniary gain? <span style="float:right">Yes <input type="checkbox"/> No <input checked="" type="checkbox"/></span></p> <p>b. Is the applicant organization a regularly chartered branch, lodge or chapter of a national organization which is operated solely for the object of a patriotic or fraternal organization or society, but not for pecuniary gain? <span style="float:right">Yes <input type="checkbox"/> No <input checked="" type="checkbox"/></span></p> <p>c. How long has the club been incorporated? <span style="float:right">Yes <input type="checkbox"/> No <input checked="" type="checkbox"/></span></p> <p>d. Has applicant occupied an establishment for three years (three years required) that was operated solely for the reasons stated above? <span style="float:right">Yes <input type="checkbox"/> No <input checked="" type="checkbox"/></span></p> |                                   |                |             |        |
| <p>21. Brew-Pub, Distillery Pub or Vintner's Restaurant applicants answer the following:</p> <p>a. Has the applicant received or applied for a Federal Permit? (Copy of permit or application must be attached) <span style="float:right">Yes <input type="checkbox"/> No <input checked="" type="checkbox"/></span></p>   |                                   |                |             |        |
| <p>22. Campus Liquor Complex applicants answer the following:</p> <p>a. Is the applicant an institution of higher education? <span style="float:right">Yes <input type="checkbox"/> No <input checked="" type="checkbox"/></span></p> <p>b. Is the applicant a person who contracts with the institution of higher education to provide food services?<br/>If "yes" please provide a copy of the contract with the institution of higher education to provide food services. <span style="float:right">Yes <input type="checkbox"/> No <input checked="" type="checkbox"/></span></p>  |                                   |                |             |        |
| <p>23. For all on-premises applicants.</p> <p>a. Hotel and Restaurant, Lodging and Entertainment, Tavern License and Campus Liquor Complex, the Registered Manager must also submit an Individual History Record<br/>- DR 8404-I and fingerprint submitted to approved State Vendor through the Vendor's website. See application checklist, Section IV, for details.</p> <p>b. For all Liquor Licensed Drugstores (LLDS) the Permitted Manager must also submit an Manager Permit Application<br/>- DR 8000 and fingerprints.</p>   |                                   |                |             |        |
| Last Name of Manager   | First Name of Manager             |                |             |        |
| N/A  | N/A                               |                |             |        |
| <p>24. Does this manager act as the manager of, or have a financial interest in, any other liquor licensed establishment in the State of Colorado? If yes, provide name, type of license and account number. <span style="float:right">Yes <input type="checkbox"/> No <input checked="" type="checkbox"/></span></p>  |                                   |                |             |        |
| <p>25. Related Facility - Campus Liquor Complex applicants answer the following:</p> <p>a. Is the related facility located within the boundaries of the Campus Liquor Complex?<br/>If yes, please provide a map of the geographical location within the Campus Liquor Complex.<br/>If no, this license type is not available for issues outside the geographical location of the Campus Liquor Complex. <span style="float:right">Yes <input type="checkbox"/> No <input checked="" type="checkbox"/></span></p> <p>b. Designated Manager for Related Facility- Campus Liquor Complex</p>  |                                   |                |             |        |
| Last Name of Manager   | First Name of Manager             |                |             |        |
| McDonald   | Patricia                          |                |             |        |
| <p>26. Tax Information. <span style="float:right">Yes <input type="checkbox"/> No <input checked="" type="checkbox"/></span></p> <p>a. Has the applicant, including its manager, partners, officer, directors, stockholders, members (LLC), managing members (LLC), or any other person with a 10% or greater financial interest in the applicant, been found in final order of a tax agency to be delinquent in the payment of any state or local taxes, penalties, or interest related to a business? <span style="float:right">Yes <input type="checkbox"/> No <input checked="" type="checkbox"/></span></p> <p>b. Has the applicant, including its manager, partners, officer, directors, stockholders, members (LLC), managing members (LLC), or any other person with a 10% or greater financial interest in the applicant failed to pay any fees or surcharges imposed pursuant to section 44-3-503, C.R.S.? <span style="float:right">Yes <input type="checkbox"/> No <input checked="" type="checkbox"/></span></p>  |                                   |                |             |        |
| <p>27. If applicant is a corporation, partnership, association or limited liability company, applicant must list all Officers, Directors, General Partners, and Managing Members. In addition, applicant must list any stockholders, partners, or members with ownership of 10% or more in the applicant. All persons listed below must also attach form DR 8404-I (Individual History Record), and make an appointment with an approved State Vendor through their website. See application checklist, Section IV, for details.</p>   |                                   |                |             |        |
| Name   | Home Address, City & State        | DOB            | Position    | %Owned |
| Patricia McDonald  | 424 Main St. Canon City, 81212 CO | 03/26/98       | SOLE member | 100%   |
| Name   | Home Address, City & State        | DOB            | Position    | %Owned |
| Name   | Home Address, City & State        | DOB            | Position    | %Owned |
| Name   | Home Address, City & State        | DOB            | Position    | %Owned |
| Name   | Home Address, City & State        | DOB            | Position    | %Owned |
| <p>** If applicant is owned 100% by a parent company, please list the designated principal officer on above.</p> <p>** Corporations - the President, Vice-President, Secretary and Treasurer must be accounted for above (Include ownership percentage if applicable)</p> <p>** If total ownership percentage disclosed here does not total 100%, applicant must check this box:</p> <p><input checked="" type="checkbox"/> Applicant affirms that no individual other than these disclosed herein owns 10% or more of the applicant and does not have financial interest in a prohibited liquor license pursuant to Article 3 or 5, C.R.S.</p>  |                                   |                |             |        |

|   |  |   |      |
|---|--|---|------|
| Name  | Type of License  | Account Number  |      |
| <b>Oath Of Applicant</b>  |  |   |      |
| I declare under penalty of perjury in the second degree that this application and all attachments are true, correct, and complete to the best of my knowledge. I also acknowledge that it is my responsibility and the responsibility of my agents and employees to comply with the provisions of the Colorado Liquor or Beer Code which affect my license.   |  |   |      |
| Authorized Signature<br><i>Patricia McDonald</i>  | Printed Name and Title<br>Patricia McDonald, Sole member   | Date<br>03/08/22  |      |
| <b>Report and Approval of Local Licensing Authority (City/County)</b>   |  |   |      |
| Date application filed with local authority<br>3-8-22   | Date of local authority hearing (for new license applicants; cannot be less than 30 days from date of application)<br>April 7 <sup>th</sup> 2022 |   |      |
| The Local Licensing Authority Hereby Affirms that each person required to file DR 8404-I (Individual History Record) or a DR 8000 (Manager Permit) has been:  |  |   |      |
| <input checked="" type="checkbox"/> Fingerprinted<br><input type="checkbox"/> Subject to background investigation, including NCIC/CCIC check for outstanding warrants   |  |   |      |
| That the local authority has conducted, or intends to conduct, an inspection of the proposed premises to ensure that the applicant is in compliance with and aware of, liquor code provisions affecting their class of license  |  |   |      |
| (Check One)   |  |   |      |
| <input type="checkbox"/> Date of inspection or anticipated date _____<br><input checked="" type="checkbox"/> Will conduct inspection upon approval of state licensing authority   |  |   |      |
| <input type="checkbox"/> Is the Liquor Licensed Drugstore (LLDS) or Retail Liquor Store (RLS) within 1,500 feet of another retail liquor license for off-premises sales in a jurisdiction with a population of > 10,0000?   |  | Yes No<br><input type="checkbox"/> <input checked="" type="checkbox"/>            |      |
| <input type="checkbox"/> Is the Liquor Licensed Drugstore(LLDS) or Retail Liquor Store (RLS) within 3,000 feet of another retail liquor license for off-premises sales in a jurisdiction with a population of < 10,0000?  |  | <input type="checkbox"/> <input checked="" type="checkbox"/>                      |      |
| <b>NOTE:</b> The distance shall be determined by a radius measurement that begins at the principal doorway of the LLDS/RLS premises for which the application is being made and ends at the principal doorway of the Licensed LLDS/RLS.   |  |   |      |
| <input type="checkbox"/> Does the Liquor-Licensed Drugstore (LLDS) have at least twenty percent (20%) of the applicant's gross annual income derived from the sale of food, during the prior twelve (12) month period?  |  | <input type="checkbox"/> <input checked="" type="checkbox"/>                      |      |
| The foregoing application has been examined; and the premises, business to be conducted, and character of the applicant are satisfactory. We do report that such license, if granted, will meet the reasonable requirements of the neighborhood and the desires of the adult inhabitants, and will comply with the provisions of Title 44, Article 4 or 3, C.R.S., and Liquor Rules. Therefore, this application is approved. |  |   |      |
| Local Licensing Authority for<br>Town of Westcliffe   | Telephone Number<br>719-783-2282   | <input checked="" type="checkbox"/> Town, City<br><input type="checkbox"/> County |      |
| Signature   | Print  | Title   | Date |
| Signature   | Print  | Title   | Date |

YAMABEEZA, LLC  
215 MAIN ST, Westcliffe CO  
Restaurant floor plan

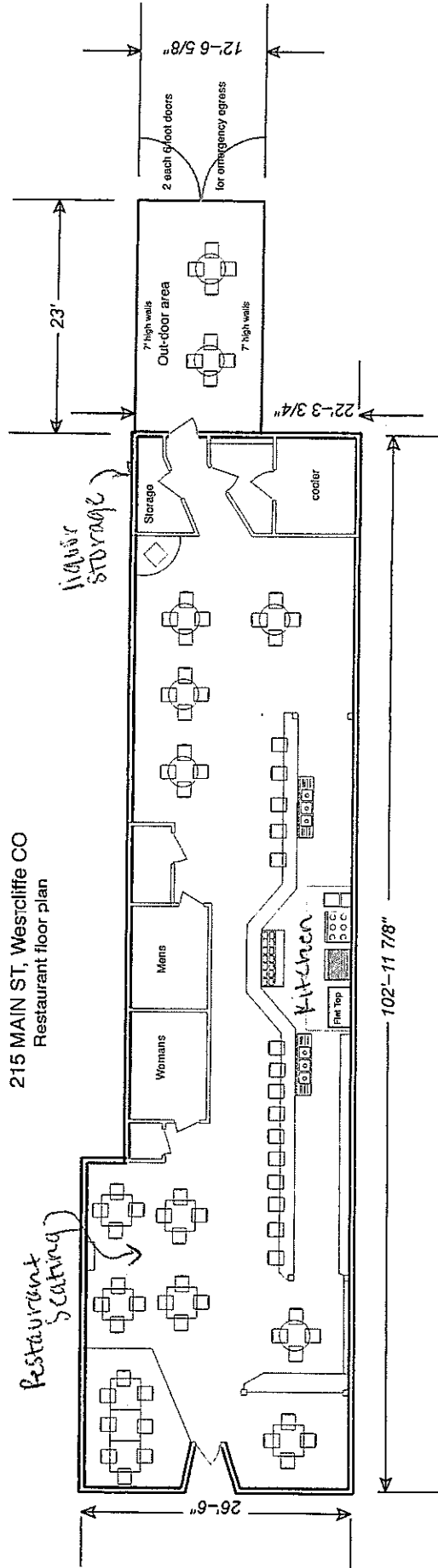

MAIN ST